



SHELLEY CRESCENT

HOUNSLOW, TW5 9BJ

£699,950
FREEHOLD

Nestled in the desirable Shelley Crescent in Heston, this charming three bedroom extended semi-detached house offers a perfect blend of comfort and convenience. Spacious throughout, the property boasts a generous living space of 1,453 square feet, making it an ideal family home.

Upon entering, you are greeted by two spacious reception rooms, providing ample space for relaxation and entertaining. The well appointed downstairs shower room adds to the practicality of the home, while the upstairs bathroom ensures that family life runs smoothly.

The property features three well proportioned bedrooms, each offering a peaceful retreat at the end of the day. The large rear garden is a standout feature, providing a wonderful outdoor space for children to play, gardening enthusiasts to flourish, or simply for enjoying the fresh air during the warmer months.

AKS
ESTATES

Shelley Crescent, Hounslow

Approximate Gross Internal Area = 1307 sq ft / 121.4 sq m
(Excluding Void)

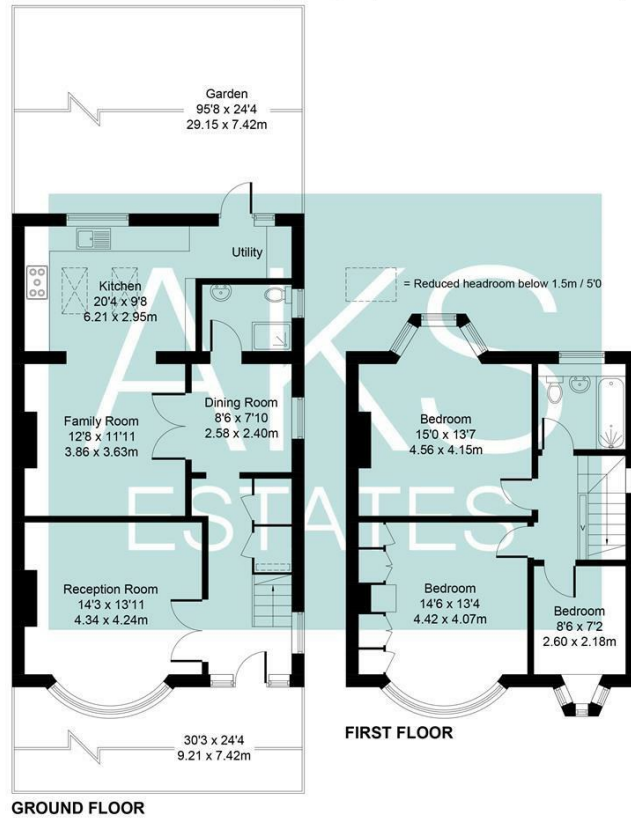

Not to Scale. Produced by © Vizion Property Marketing 2026
For Illustrative Purposes Only.

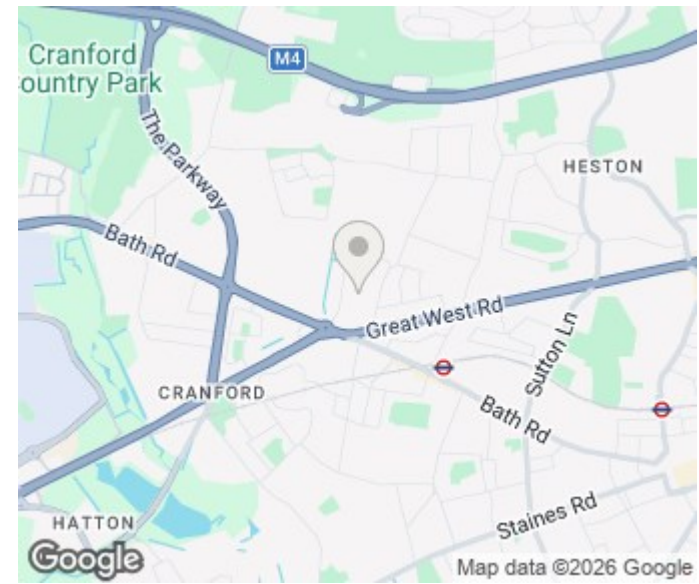

Energy Efficiency Rating		Current	Potential
Very energy efficient - lower running costs			
(92 plus) A			
(81-91) B			
(69-80) C			79
(55-68) D	66		
(39-54) E			
(21-38) F			
(1-20) G			
Not energy efficient - higher running costs			
England & Wales		EU Directive 2002/91/EC	

Agents Note: Whilst every care has been taken to prepare these particulars, they are for guidance purposes only. All measurements are approximate and are for general guidance purposes only and whilst every care has been taken to ensure their accuracy, they should not be relied upon and potential buyers/tenants are advised to recheck the measurements

Heston
131A Heston Road
Hounslow
TW5 0RF

020 8059 0595
shiv@aksestates.co.uk
aksestates.co.uk

